



**RUSHIL**  
DECOR LIMITED  
WE'LL MAKE IT

# TOPAZ



KITCHEN TOPS  
COUNTER TOPS



# Index

About Topaz .....	02
Inspiration .....	03
Panel Specifications .....	05
Kitchen Ideas .....	06
Features .....	07
Construction Overview .....	09
Disclaimer .....	12
Application Scope .....	13
• Public Area .....	16
• Work & Wellness .....	18
• Residential .....	20
• Transformation .....	22
Marble - Granite - Stone .....	23
Wood & Veneer .....	55
Solid & Unicolor .....	71
Decor Overview .....	77
Finishes & Texture .....	79
Certifications & Standards .....	92
Technical Datasheet .....	93
Product Program .....	99



# TOPAZ

Where refined design meets everyday performance, TOPAZ stands as a premium surface solution crafted for contemporary living. Created for kitchen tops, islands, dining tables, upstands, backsplashes and a wide range of interior applications, it brings together elegance, durability and functionality in perfect harmony. Designed to complement modern lifestyles, it transforms essential surfaces into statement elements that define the character of a space.

Engineered to handle the demands of daily use, these surfaces offer exceptional resistance to heat, moisture, and wear while remaining easy to maintain. Each finish is thoughtfully developed to deliver both visual appeal and reliable performance — from luxurious marble-inspired patterns and expressive stone textures to sophisticated solid tones that suit every design language. With a focus on precision and quality, every surface reflects a balance of strength and refined craftsmanship.

Ideal for residential and commercial interiors alike, this collection empowers architects, designers and homeowners to create spaces that are both functional and visually compelling. Whether shaping a statement kitchen island, a seamless backsplash, or an elegant dining surface, it enhances interiors with lasting style and dependable performance. More than just a surface, it is a design element that elevates everyday environments with timeless appeal and modern sophistication.



# Convert Your Thoughts

When design meets everyday performance, TOPAZ is created — a surface solution that goes beyond function to define modern living. Crafted for kitchen tops, islands, dining tables, upstands and backsplashes, it brings together refined aesthetics and dependable strength. Built for spaces that are lived in and loved daily, it transforms interiors with a presence that is contemporary, elegant and enduring.

Inspired by the idea that beauty should perform as well as it looks, each surface is engineered to handle the demands of modern lifestyles. Resistant to heat, moisture and daily wear, it offers a durable and easy-to-maintain solution for busy kitchens and dining spaces. Beneath its strength lies thoughtful design — rich marble patterns, expressive stones and sophisticated solid tones that enhance every surface they touch. It is not just a material, but an expression of style and practicality working in harmony.

Created for homeowners, designers and architects who value both aesthetics and reliability, this surface solution elevates interiors with seamless functionality. From statement kitchen islands to elegant dining tables and refined backsplashes, it enables spaces that are both visually striking and highly practical. Every detail reflects a balance of craftsmanship, innovation and contemporary design thinking.

With TOPAZ, interiors gain more than a surface — they gain character, durability and a timeless design language that enhances everyday living.





# Panel Specifications\*\*

Available in multiple panel specifications to suit diverse Interior applications.

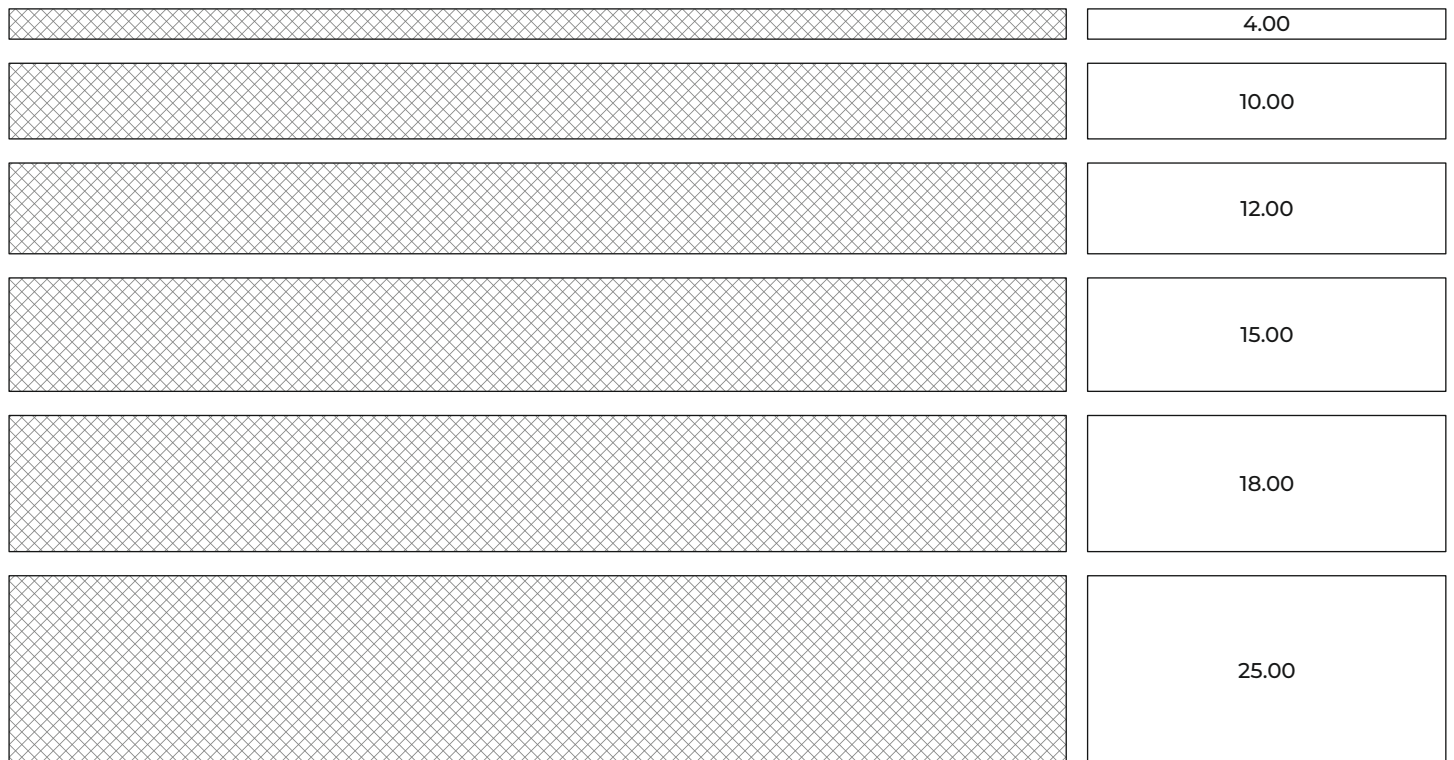
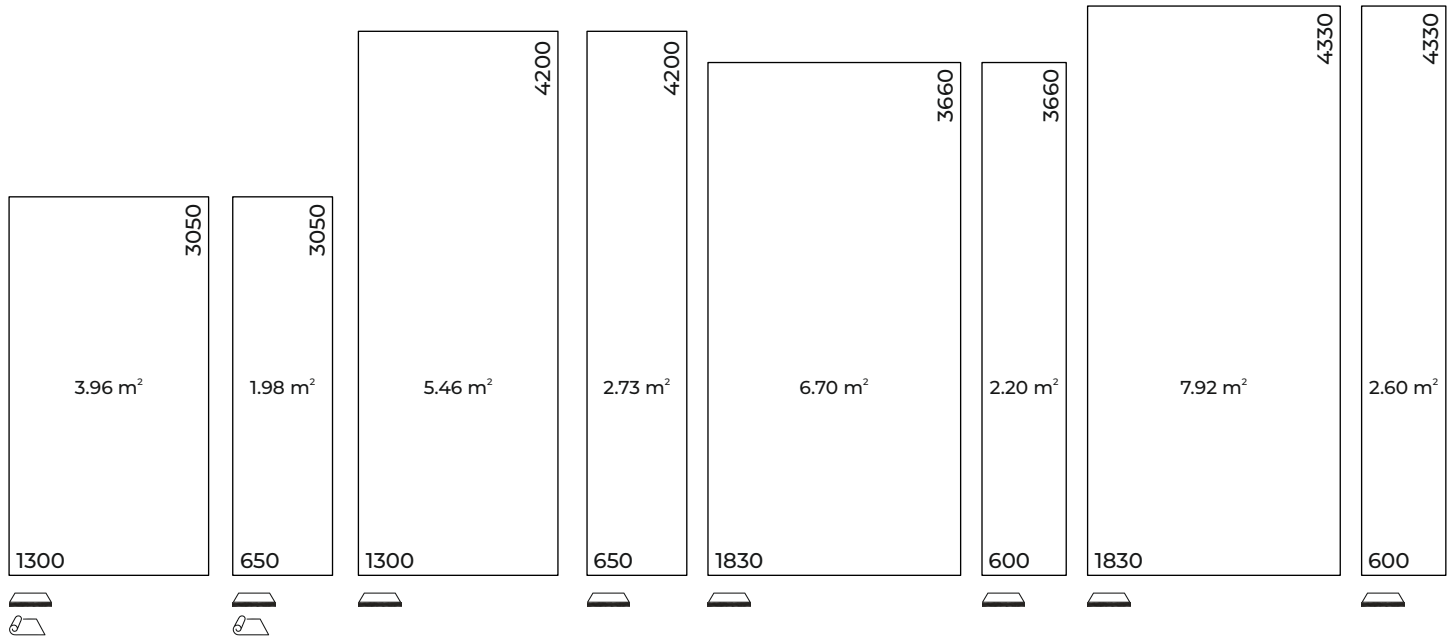

**COMPACT**  
4.00 to 25.00



**HPL**  
0.6 to 25.00

\*All Dimensions are in mm

# Kitchen Ideas

Explore smart kitchen configurations designed for functionality, efficiency and modern living.

## Galley | Single

A streamlined, space-efficient layout with all elements aligned on one wall, ideal for compact kitchens and quick workflow.

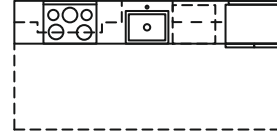

## Galley | Two Rows

Parallel counters create an efficient work triangle, offering maximum functionality and storage in limited space.

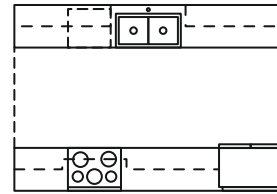

## L-Shape

Designed for flexibility, this layout utilizes two adjoining walls to create an open and ergonomic kitchen workspace.

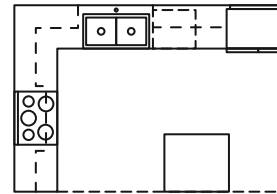

## U-Shape

Surrounding the user on three sides, this layout provides ample counter space, storage and efficient movement for busy kitchens.

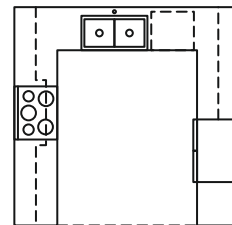

## Broken Peninsula Kitchen

A modern variation with a partially extended counter that adds workspace and casual seating while maintaining openness.

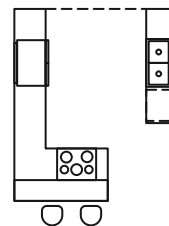

## G-Shape | Peninsula Kitchen

An extended U-shaped layout with an added peninsula, delivering extra storage, preparation area and a social cooking environment.

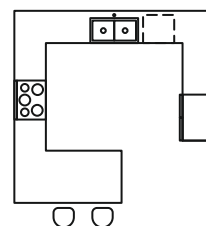

# Surface conditions\*



Moisture Resistant



Optimally Lightfast



Scratch Resistant



Abrasion Resistant



Impact Resistant



Fire Resistant



Water Resistant



Burn Resistant

# Design freedom and efficiency



Design Finishes



CNC Patterning



6-Size Advantage

# Installation and Maintenance



Quick installation



Decor on both sides



Easy to clean



Antibacterial



Resistant to solvents



Food Safe



# Construction Overview

This diagram illustrates the multi-layered construction of TOPAZ. It features a protective overlay and decorative layers treated with MF resin to ensure enhanced surface durability, resistance and a refined finish suited for interior applications.

The core is built from multiple layers of kraft paper impregnated with PF resin, delivering superior structural strength and stability. Compressed under high pressure, these layers form a dense, impact-resistant and long-lasting panel engineered for dependable performance across table tops, upstands and backsplash surfaces.

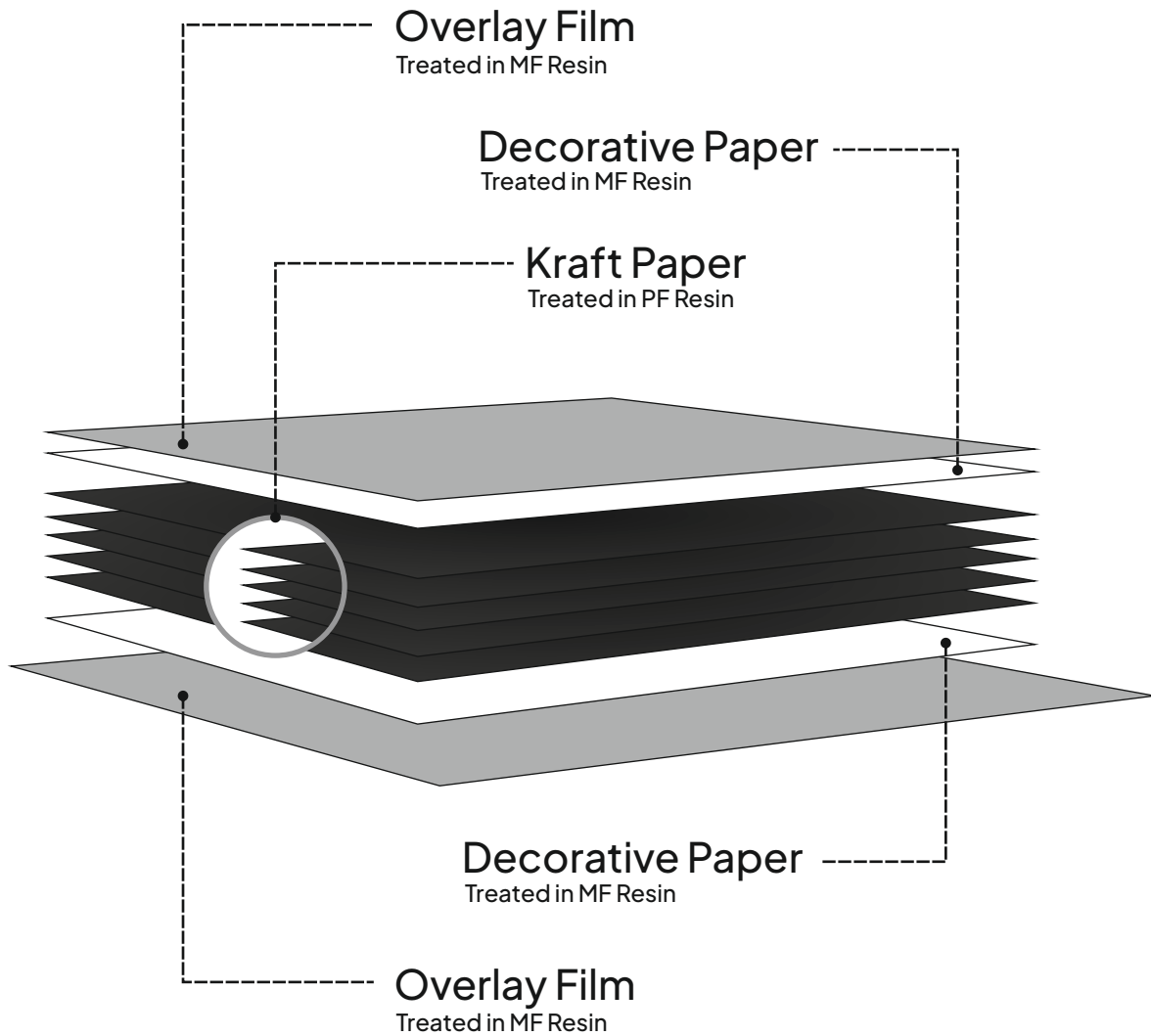

## Core Colors

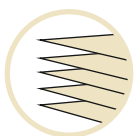

Quartz



Crystal



Silver



Anthracite



Carbon



Noir



Natural

\*Overlay Film available on both sides on demand  
\*FR Grade available on demand as per MOQ

# Construction Overview

A refined collection of contemporary surface designs showcasing the versatility of TOPAZ. Featuring elegant marble, stone and textured finishes, these panels are crafted to enhance table tops, upstands and backsplash applications with a premium aesthetic.

Engineered for durability and visual appeal, the range combines modern design with reliable performance, offering sophisticated surface solutions that elevate both residential and commercial interiors.





# Disclaimer

All application visuals and renders shown in this catalogue are for illustrative purposes only. Actual product appearance and application may vary.

Due to printing limitations, color and design reproduction in this catalogue may differ slightly from the actual product. Customers are advised to refer to physical samples before final selection or confirmation.

All dimensions mentioned in this catalogue are in millimetres (mm) unless otherwise specified. Where different units are used, they will be clearly indicated alongside the dimensions.

The company reserves the right to modify, update, or discontinue any design, shade, or specification without prior notice.



# Application Scope

From concept to completion, TOPAZ supports every stage of your design journey.

Offering virtually limitless design possibilities, it provides the freedom to create remarkable spaces while staying within budget. From crafting bold kitchen statements and elegant dining surfaces to enhancing modern workspaces with striking textures and colors, the possibilities are endless. Designed for both homes and commercial interiors, it brings together visual appeal and everyday practicality—ensuring surfaces are never ordinary, only exceptional.



Kitchen Tops



Backsplashes



Worktops



Breakfast bars



Upstands



# Public Areas



# Work & Wellness



# Residential



# Transformation



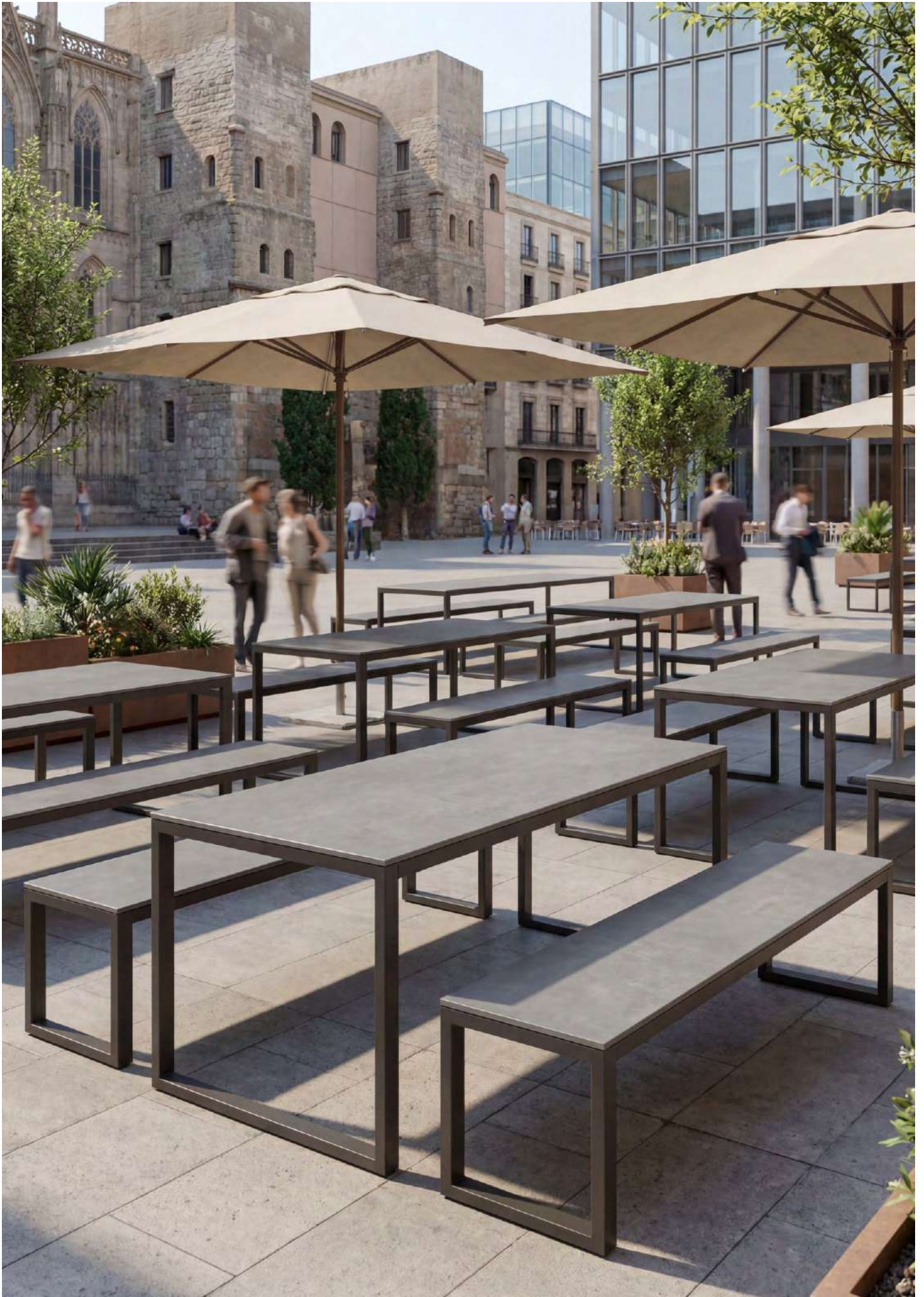

# Public Areas

TOPAZ brings refined surface solutions to modern public and shared spaces. With a versatile range of contemporary decors and finishes, it integrates seamlessly into cafés, dining areas, lounges, and commercial interiors while meeting the functional demands of high-usage environments.

Combining visual sophistication with dependable performance, it offers durable and easy-to-maintain surfaces for table tops, counters and feature areas. Designed to balance aesthetics with practicality, it delivers a complete surface solution—stylish, resilient and ready to enhance every public space.



Public buildings



Government offices



Hospitals



Schools



Education



Health



Museums



Art galleries



Libraries



# Work & Wellness

TOPAZ brings a refined balance of design and durability to modern workspaces and wellness environments. With a versatile range of contemporary finishes, it enhances office pantries, café counters, meeting tables and collaborative spaces with surfaces that are both stylish and practical.

Engineered for daily use, it offers reliable resistance, easy maintenance and lasting visual appeal creating interiors that feel welcoming, functional and thoughtfully designed. From professional workspaces to wellness and hospitality areas, it delivers surface solutions that combine comfort, performance and modern sophistication.



Retail properties



Commercial offices



Warehouses



Inner city regeneration



Industrial buildings



Sporting arenas



Entertainment



Leisure



Theatres



# Residential

TOPAZ surfaces are crafted to meet the highest standards of modern residential interiors. Ideal for kitchen tops, islands, dining tables, upstands and backsplashes, they combine refined finishes with dependable durability and easy maintenance for everyday living.

Perfectly suited to contemporary homes, the collection brings together elegant marble, stone and solid finishes that add depth, character and a premium feel to every space. Designed for both beauty and practicality, these surfaces offer long-lasting performance, effortless upkeep and timeless style making them a smart and sophisticated choice for modern homeowners.



Private housing



Apartments



Cooperative housing



Housing associations



Communal housing



Collective housing



# Transformation

TOPAZ is designed to transform everyday interiors with style and performance. Durable, easy to maintain and available in a wide range of contemporary finishes, it offers the perfect solution for upgrading kitchen tops, islands, dining tables, upstands and backsplashes.

Balancing aesthetics, strength and practicality, it delivers modern surface standards that elevate spaces with refined design, lasting reliability and timeless appeal.



Urban renewal



Hospitals



Schools



Retail properties



Commercial



Warehouses



Industrial

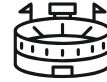

Sport



Education



Health



Entertainment



Leisure

# Marble - Granite - Stone

TOPAZ surfaces are crafted to elevate modern interiors with refined performance and style. Designed for table tops, upstands and backsplashes, they offer a perfect blend of durability, elegance and everyday practicality. Easy to maintain and available in a wide range of contemporary finishes, TOPAZ delivers a sophisticated surface solution that enhances both residential and commercial spaces. Balancing aesthetics, strength and functionality, it sets a new standard for modern surface applications.







9362 Crystal Alba



8582 Bonito



9322 Calacatta Elegance

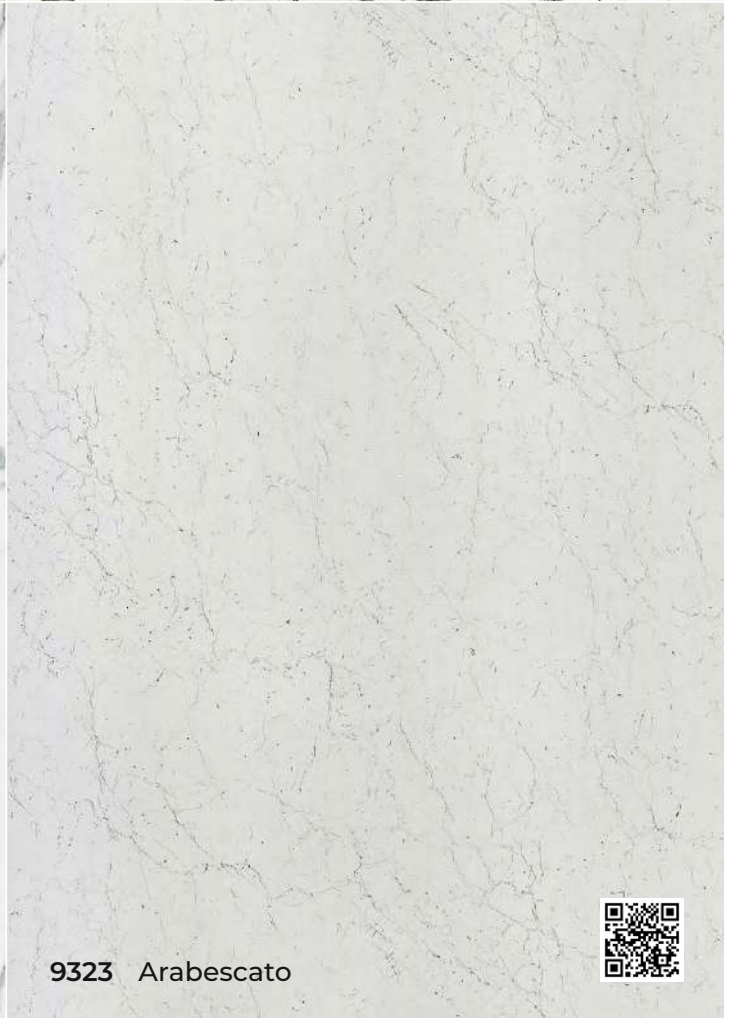

9323 Arabescato









9344 Bianco Venato



9363 Lunara Stone



12504 Rose Gold Marble



9364 Golden Calma





6612 Carrara Mist

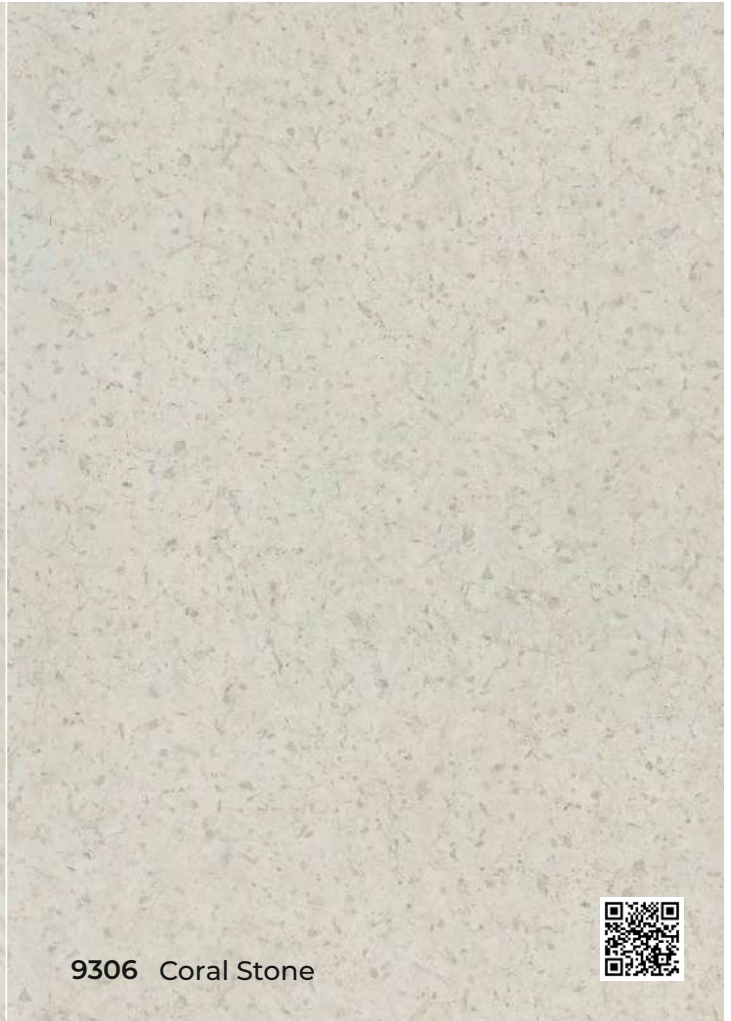

9306 Coral Stone



9420 Diamond Tufting









9333 Lunar Stone



9359 Terra Crema



9360 Terra Grigio





12508 Travertino Grigio Light



12509 Travertino Grigio Dark

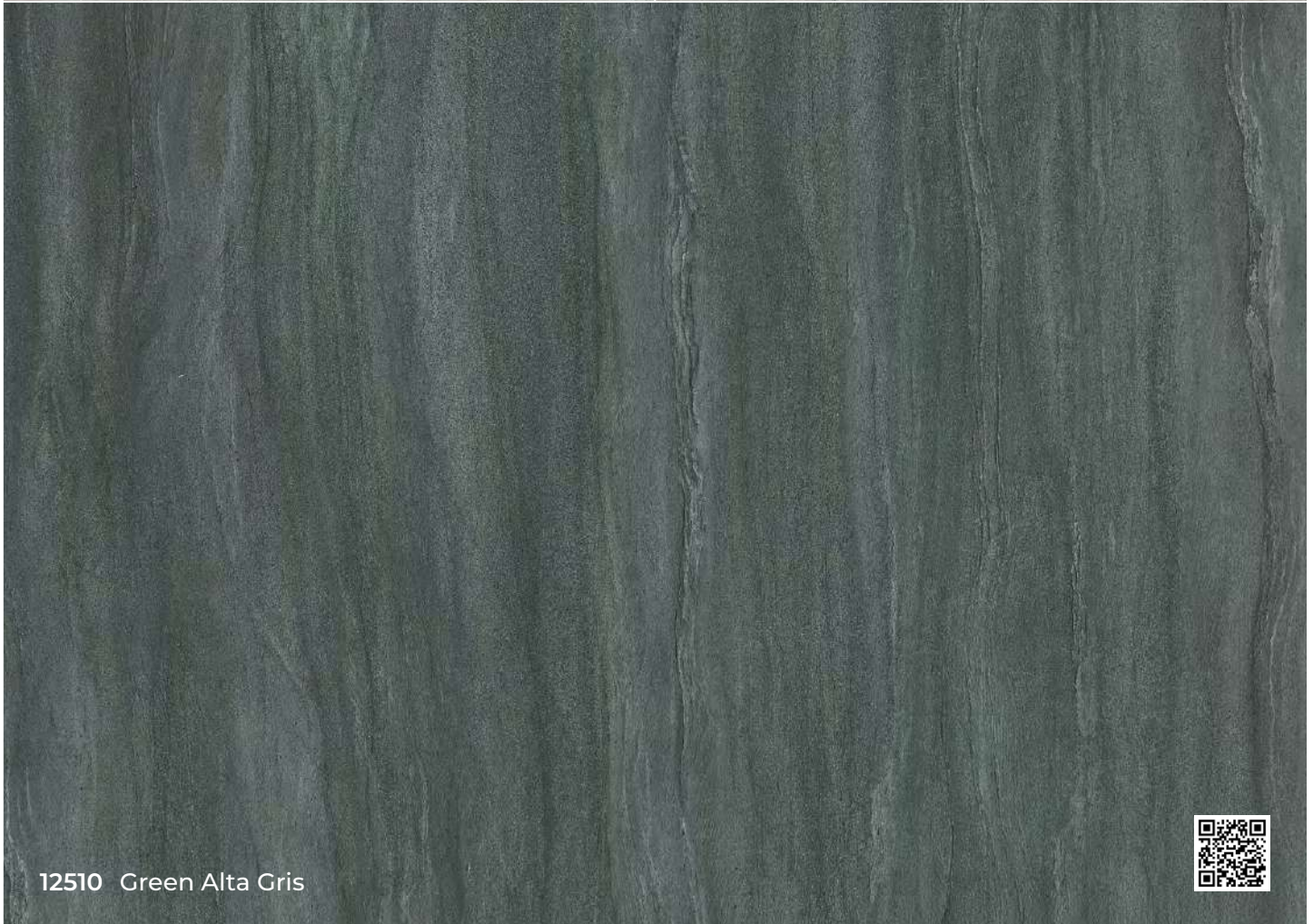

12510 Green Alta Gris









8569 Kamala



8697 Travertin Light



8698 Travertin Dark



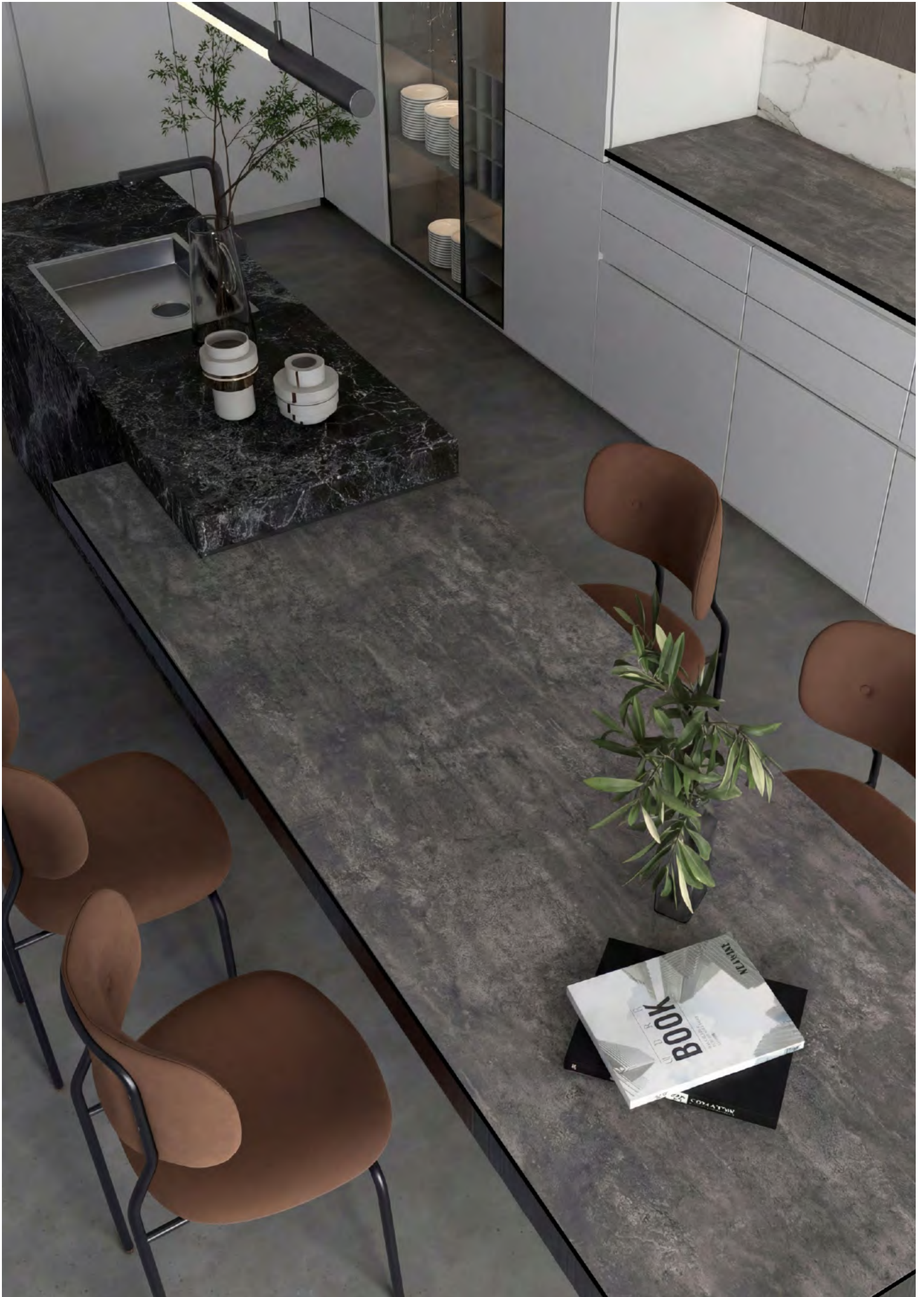



9332 Stormy Stone



9327 Grigio Carnico

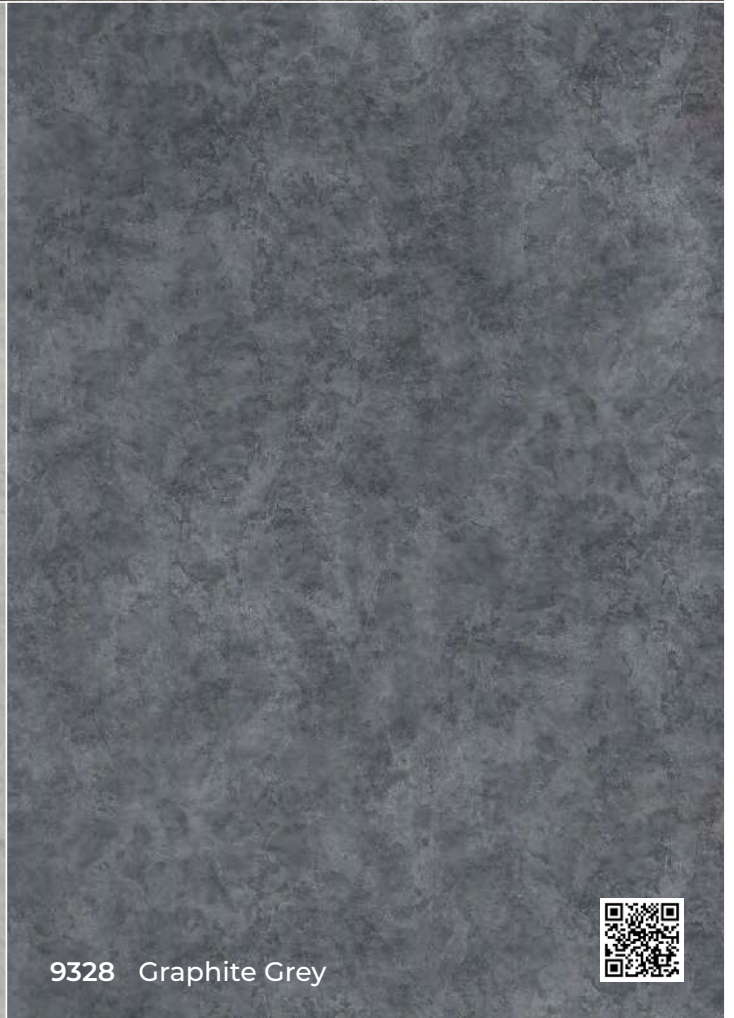

9328 Graphite Grey





9330 Pietra Grey

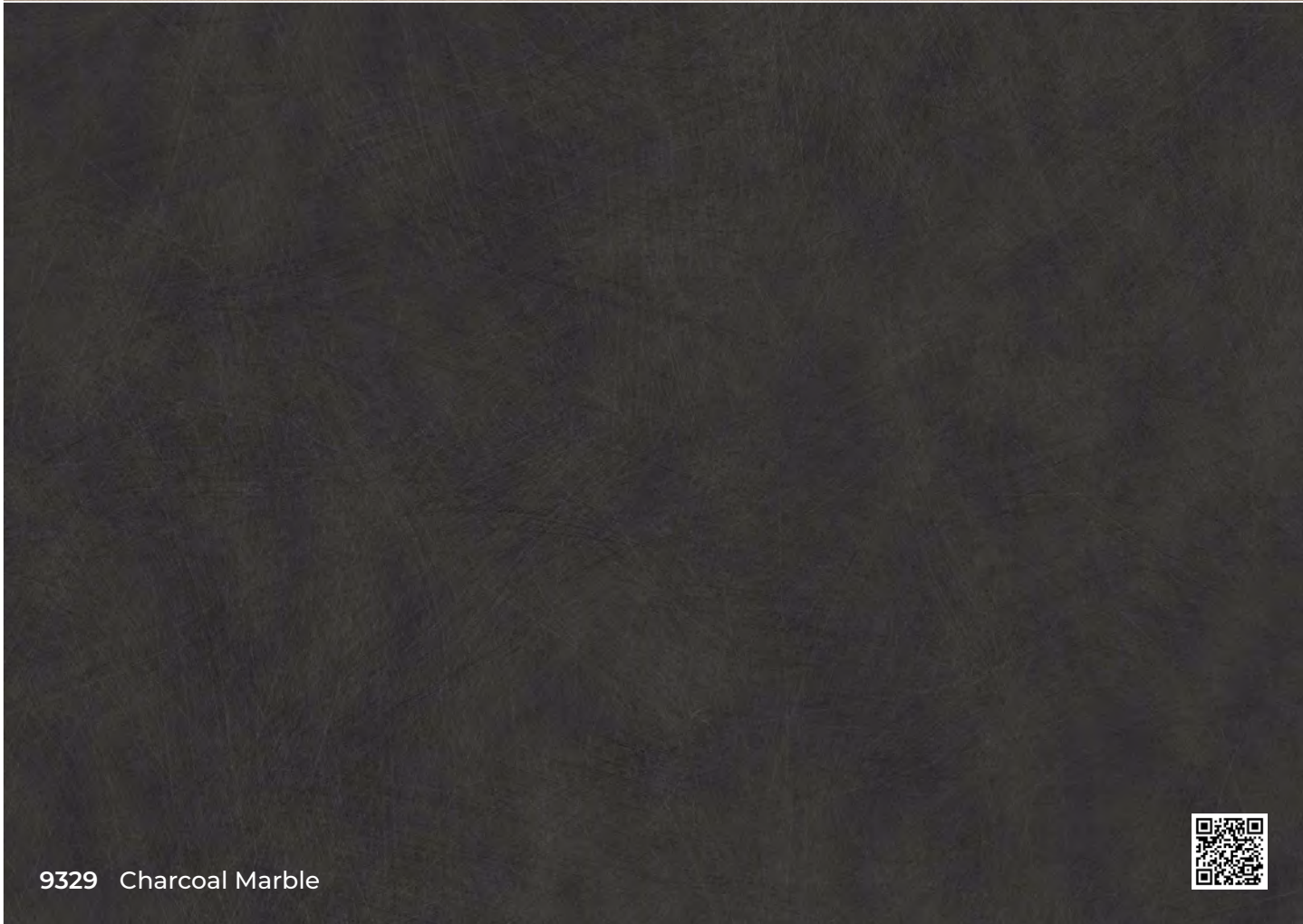

9329 Charcoal Marble







3100 Paris Brown



3200 Paris Grey







9372 Nordic Ash



8653 Perito



6613 Luna Marble



8913 Moiten Granite







9361 Nordic Grey



8656 Sinope Marble



9324 Tuscany Grey

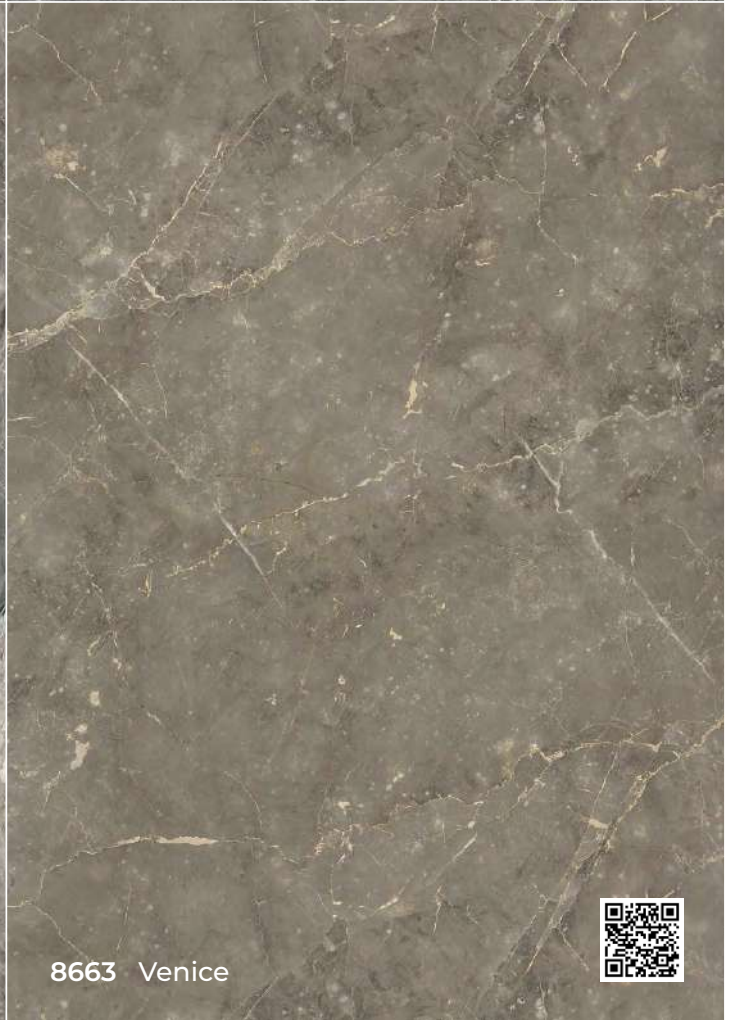

8663 Venice





1431 Desert Mirage



1414 Creamy Onyx



1418 Desert Stone









9416 Grey Caldera



9417 Graphite Strata



9418 Charcoal Quarry



9419 Burnt Orange





9366 Carbon Strata

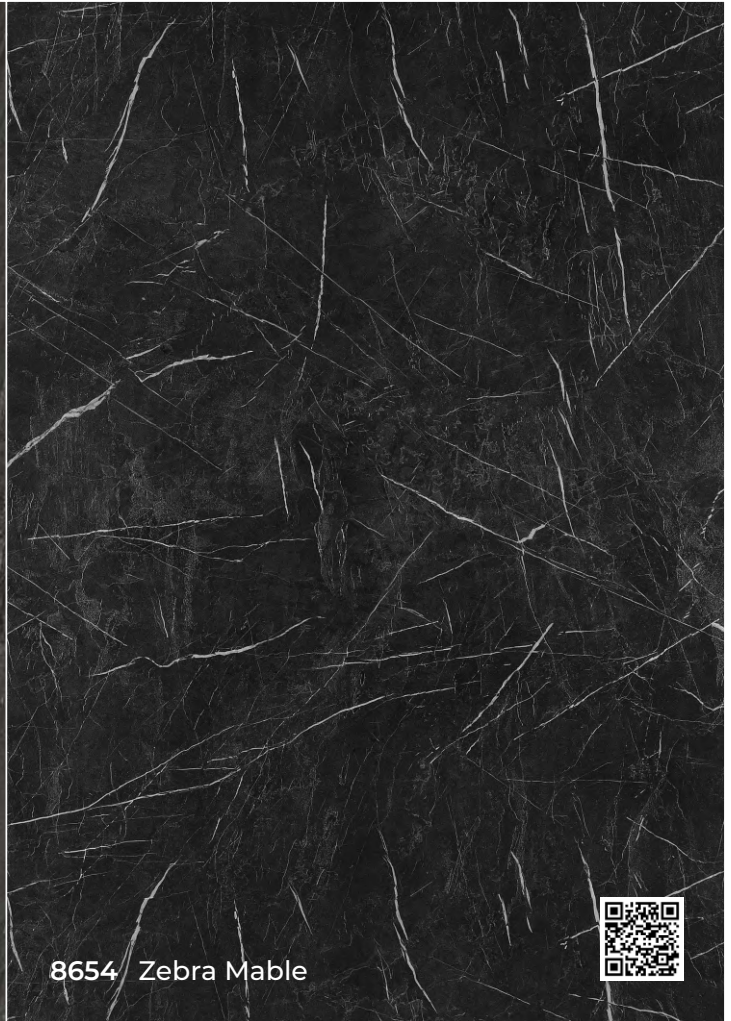

8654 Zebra Marble

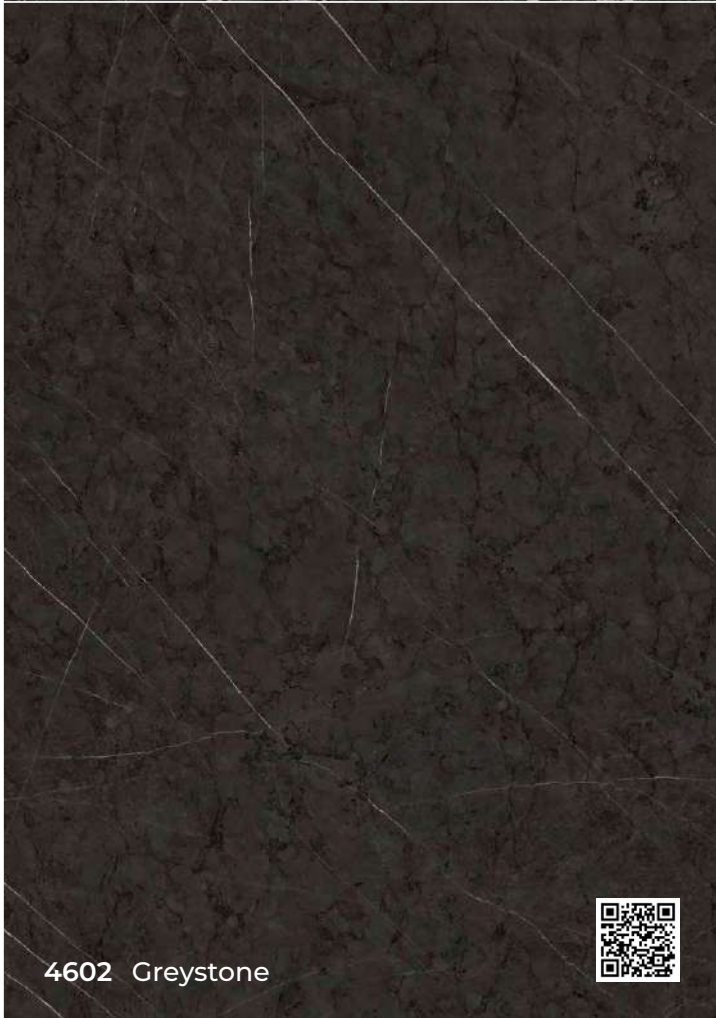

4602 Greystone

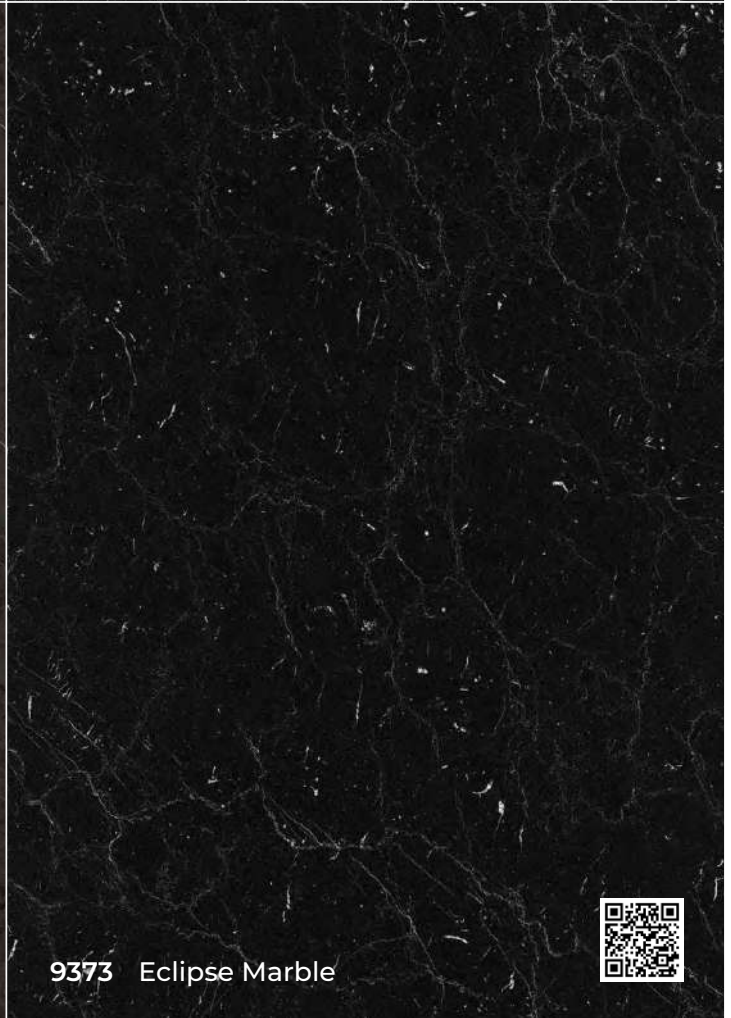

9373 Eclipse Marble









9325 Midnight Marquina



9326 Midnight Onyx



9365 Regal Onyx



9374 Eclipse Gold



# Wood & Veneer

Engineered to enhance modern interiors with style and performance, this surface solution is ideal for table tops, upstands and backsplashes. It offers a durable and cost-effective way to elevate everyday spaces while ensuring long-lasting reliability. Easy to maintain and available in a wide range of contemporary finishes, it provides a seamless upgrade for both residential and commercial environments.







9404 Baltic Birchwood



7599 Moldau Acacia Light



9379 Ivory Softwood



9412 Ivory Beech





9413 Pearl Wood



9414 Vanilla Birch



9371 Nordic Maple



7632 Thansau Maple





8536 Canyon Wood Light



9407 Vintage Timber Light



9137 Nogalino



9375 Timbercliff Umber







4663 Santana Oak Light



9321 Vintage Barrel Oak



9402 Baltic Maple



9356 Espresso Oak





9403 European Alder



1130 Bavarian Beech



9357 Caramel Teak



8537 Canyon Wood Dark





8627 Novecento Pine



9411 Royal Beech



2164 Malasian Cherry



7129 Mangfall Beech





4664 Santana Oak Dark



9378 Shadowcrest Wood



9410 Warmwood Elite





9405 Heritage Alder



1400 Walnut Tiepolo



8625 Lyon Walnut





9406 Toffee Timber



3152 Moldau Acacia



9376 Heritage Brownwood



8626 Columbia Walnut





9408 Vintage Timber Dark



8629 Khaya Mahogany Dark



9409 Natural Teakwood



4538 Bengali Mango Dark





9377 Strata Darkwood



9367 Mocha Timber



9415 Elite Walnut





# Solid & Unicolor

Designed to enhance modern interiors with clean style and reliable performance, this surface solution is ideal for table tops, upstands and backsplashes. Featuring solid and unicolor finishes, it offers a sleek and uniform appearance that complements contemporary spaces. Durable, easy to maintain and cost-effective, it provides a smart solution for creating refined and long-lasting surfaces.





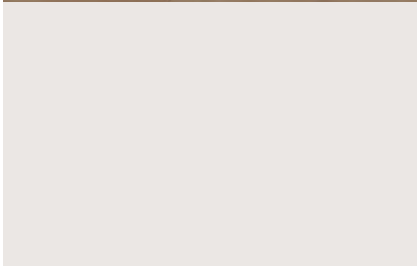

**4001**  
Milky White

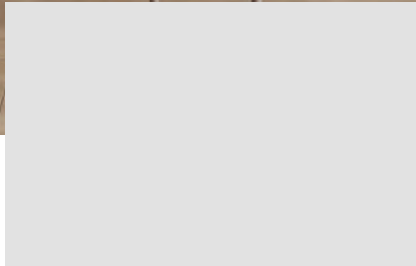

**3001**  
Snow White

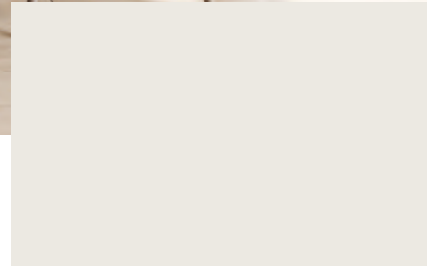

**1065**  
Ivory Pearl

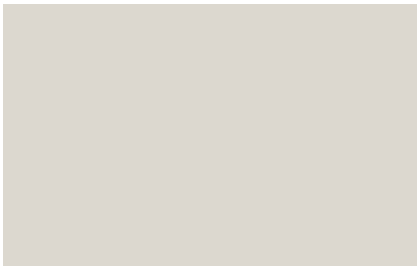

**1089**  
Pale Sand

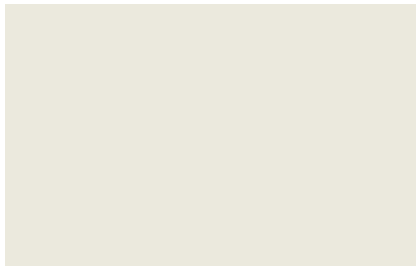

**1064**  
Cream Soft



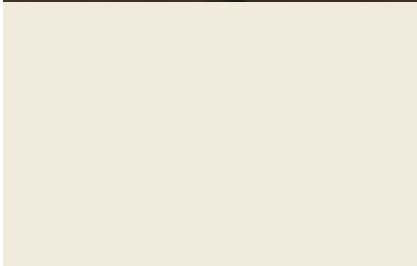

6002  
Snowflake

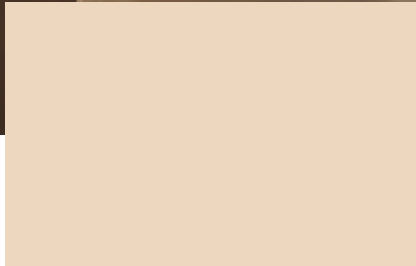

1069  
Cream Sand



1060  
Soft Beige

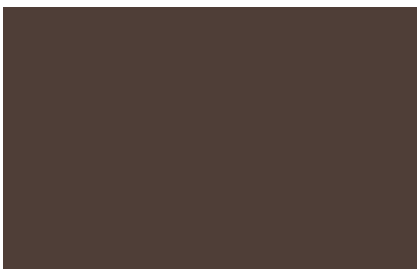

1084  
Dark Cocoa





1070  
Silver Tone

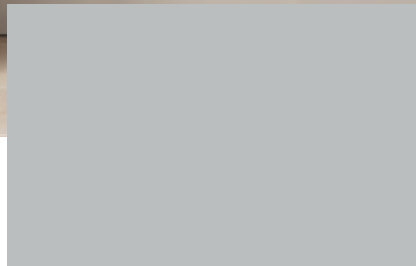

2008  
Grey



1071  
Cement Light



1076  
Urban Ash



1078  
Warm Taupe



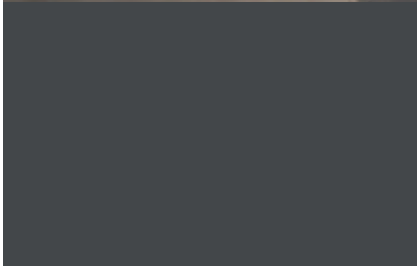

**1057**  
Graphite Dark

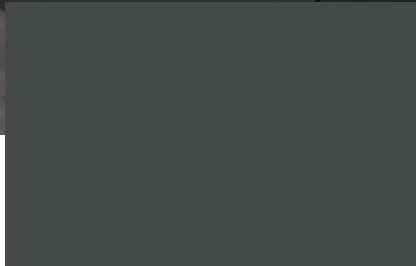

**7057**  
Carbon Grey

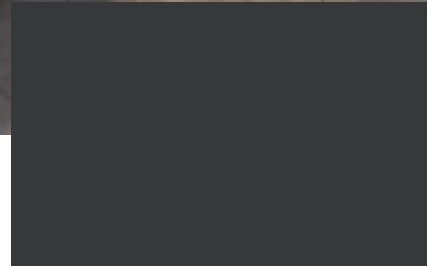

**1015**  
Jade Black



# Decor Overview

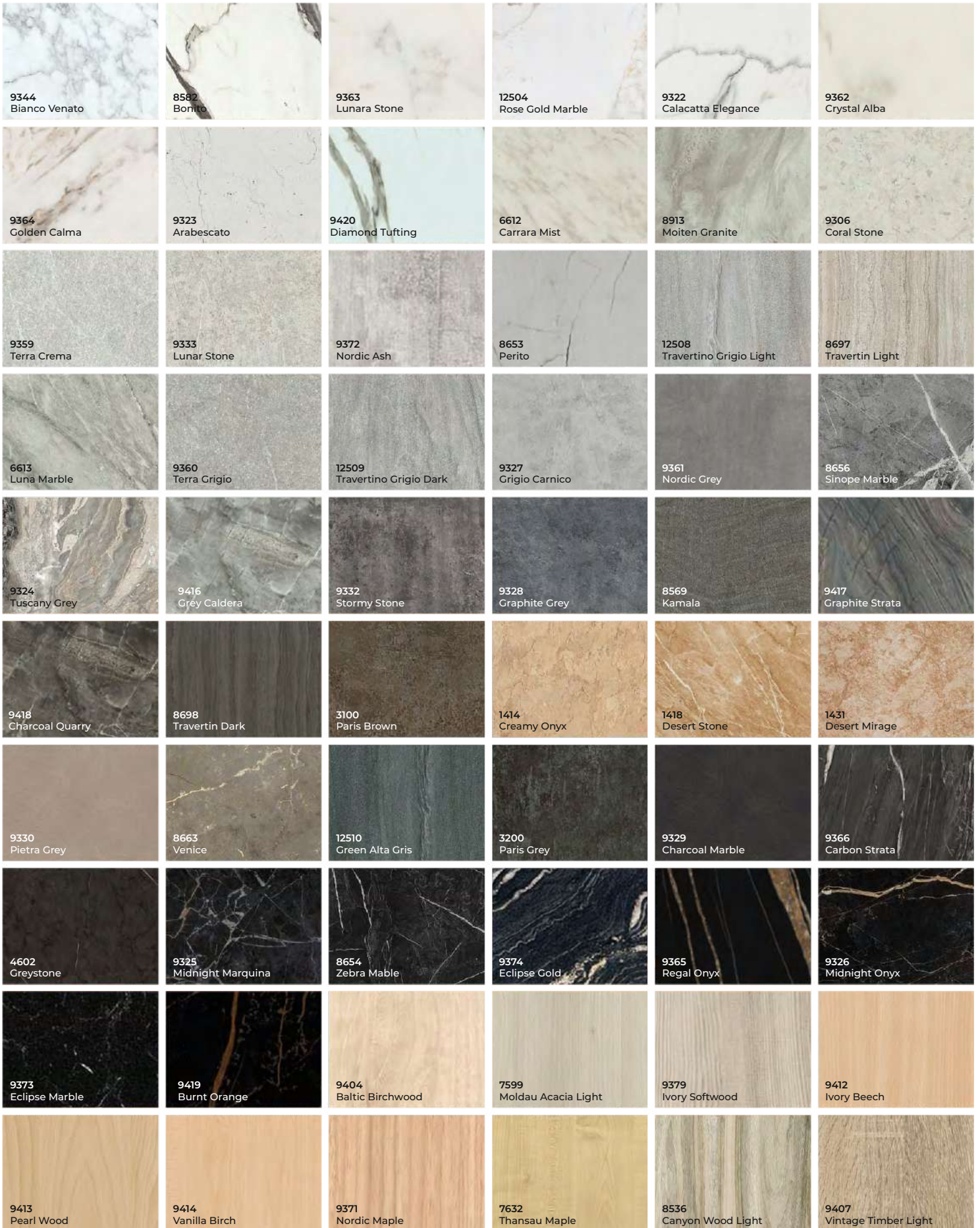

 <p>9137 Nogalino</p>	 <p>9375 Timbercliff Umber</p>	 <p>4663 Santana Oak Light</p>	 <p>9321 Vintage Barrel Oak</p>	 <p>9402 Baltic Maple</p>	 <p>9356 Espresso Oak</p>
 <p>9403 European Alder</p>	 <p>1130 Bavarian Beech</p>	 <p>9357 Caramel Teak</p>	 <p>8537 Canyon Wood Dark</p>	 <p>8627 Novecento Pine</p>	 <p>9411 Royal Beech</p>
 <p>2164 Malasian Cherry</p>	 <p>7129 Mangfall Beech</p>	 <p>4664 Santana Oak Dark</p>	 <p>9378 Shadowcrest Wood</p>	 <p>1400 Walnut Tiepolo</p>	 <p>9410 Warmwood Elite</p>
 <p>9405 Heritage Alder</p>	 <p>8625 Lyon Walnut</p>	 <p>9406 Toffee Timber</p>	 <p>3152 Moldau Acacia</p>	 <p>9376 Heritage Brownwood</p>	 <p>8626 Columbia Walnut</p>
 <p>9408 Vintage Timber Dark</p>	 <p>8629 Khaya Mahogany Dark</p>	 <p>9409 Natural Teakwood</p>	 <p>4538 Bengali Mango Dark</p>	 <p>9377 Strata Darkwood</p>	 <p>9367 Mocha Timber</p>
 <p>9415 Elite Walnut</p>	 <p>4001 Milky White</p>	 <p>3001 Snow White</p>	 <p>1065 Ivory Pearl</p>	 <p>6002 Snowflake</p>	 <p>1064 Cream Soft</p>
 <p>1089 Pale Sand</p>	 <p>1069 Cream Sand</p>	 <p>1060 Soft Beige</p>	 <p>1070 Silver Tone</p>	 <p>2008 Grey</p>	 <p>1071 Cement Light</p>
 <p>1076 Urban Ash</p>	 <p>1078 Warm Taupe</p>	 <p>1057 Graphite Dark</p>	 <p>1084 Dark Cocoa</p>	 <p>7057 Carbon Grey</p>	 <p>1015 Jade Black</p>

# Finishes

Depth, Detail, Distinction

More than flat finishes, our laminate textures offer a rich sensory layer to your designs. The interplay of light and surface brings out the character of wood or stone-like finishes. Each panel feels handcrafted — elevating both look and feel.

MF-Matt

Elegant matt finish that delivers a smooth, non-reflective surface with a premium modern feel. Designed to resist fingerprints and glare, ensuring timeless style with effortless maintenance.



## GF - Gloss

High-gloss finish that enhances surfaces with a rich, reflective shine and luxurious appeal. Designed to amplify depth and brightness while offering a smooth, easy-to-clean surface for modern interiors.

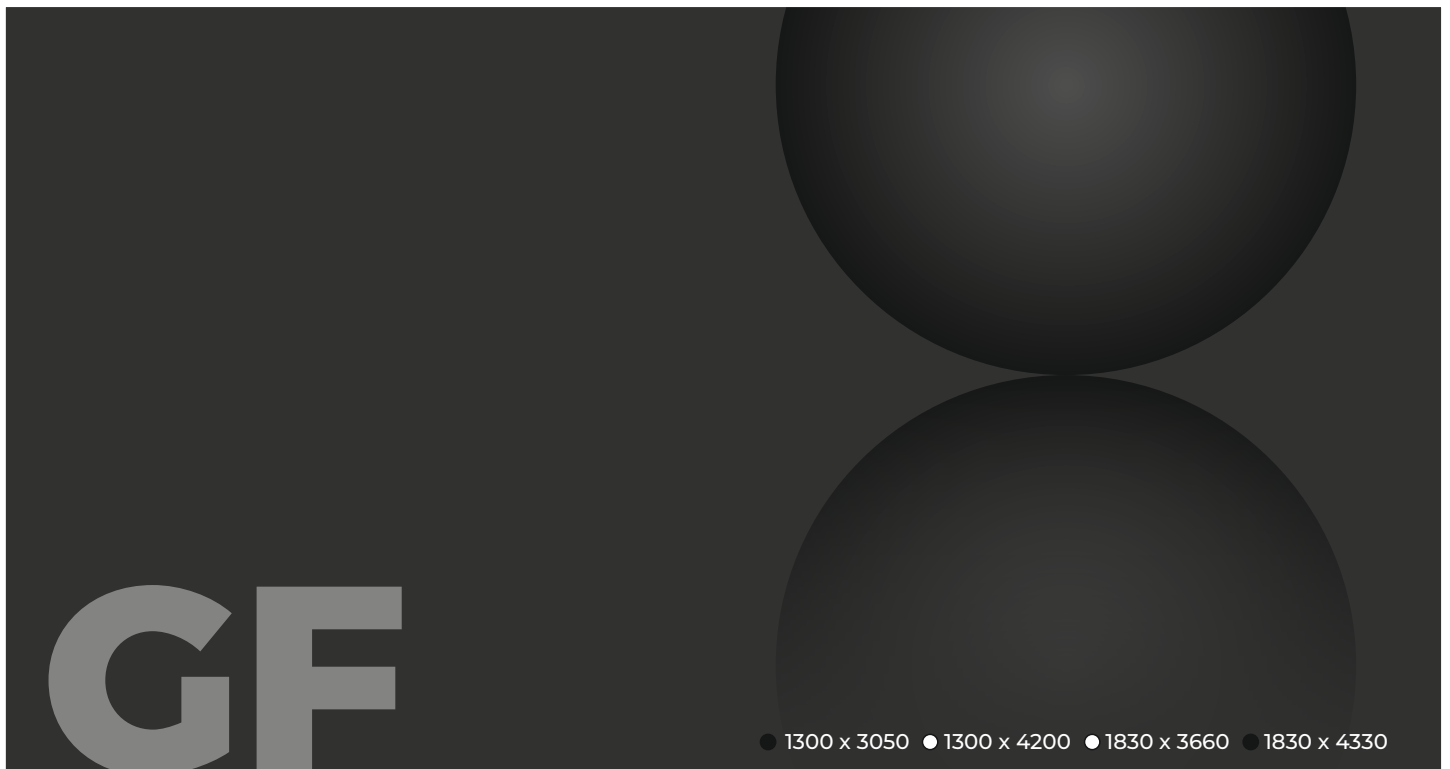

## SF - Suede

Soft suede finish that brings a smooth, velvety texture with a sophisticated matte appeal. Designed to add warmth, depth and a refined tactile experience to contemporary interior surfaces.



# Textures

Feel, Form, Finesse

A texture you don't just see, but truly feel — crafted to mirror the touch of nature. Every detail comes alive under your hand, bringing depth and authenticity to every surface

BT - Brilliant Stone

Brilliant Stone finish captures the richness of natural stone with enhanced depth and subtle sheen. Crafted to deliver a luxurious, durable surface that adds timeless elegance to modern interiors..

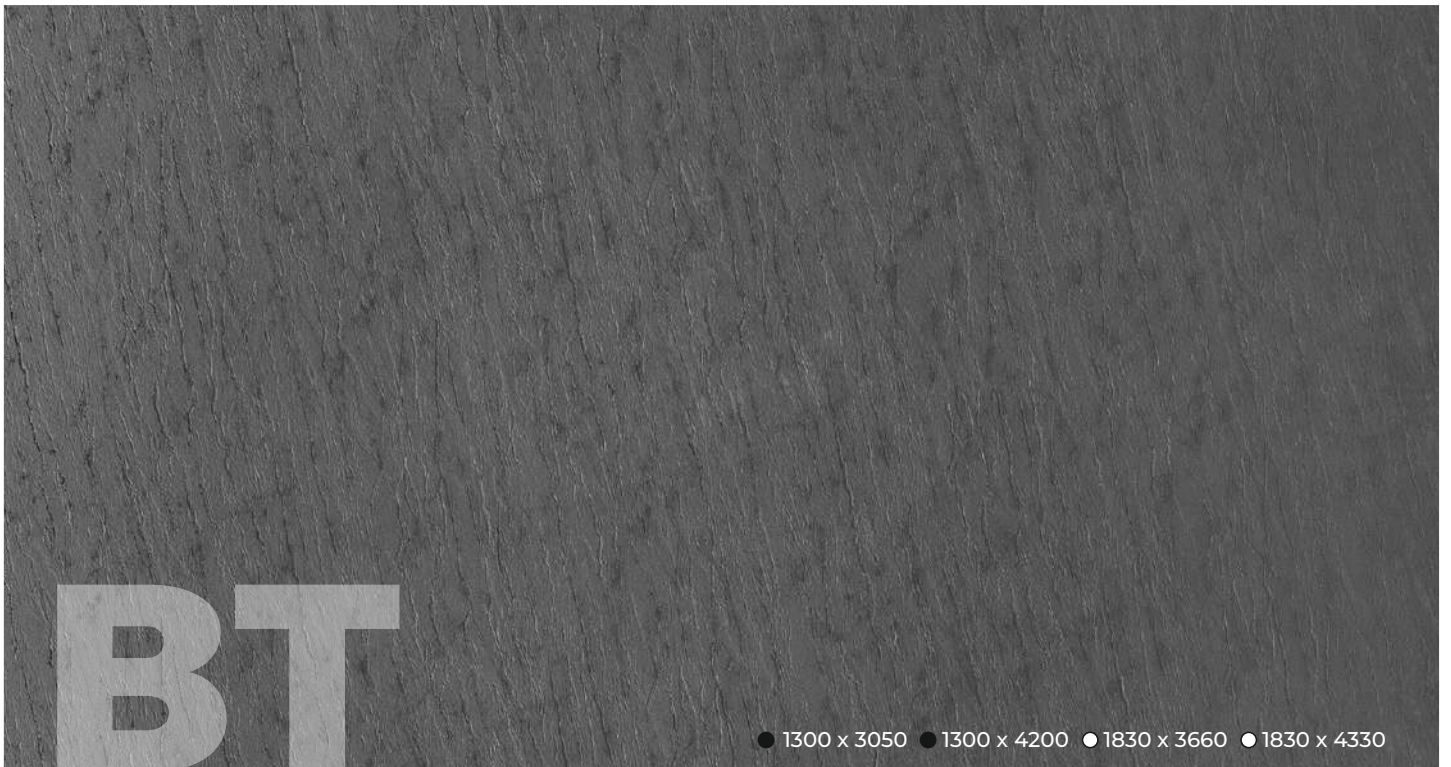

### CM - Classic Matt

Classic Matt finish offers a timeless, smooth surface with a subtle, elegant appearance. Designed for everyday durability, it delivers a refined look that complements both modern and traditional interiors.



### GS - Glitter Stone

Glitter Stone finish blends natural stone character with a subtle sparkling effect for a striking visual appeal. Designed to add depth, texture and a touch of luxury while maintaining durability for everyday interior surfaces.



## NTF - Natural Timber Feel

Natural Timber Feel captures the warmth and texture of real wood with an authentic, tactile surface. Designed to bring organic elegance and lasting durability to contemporary interior spaces.

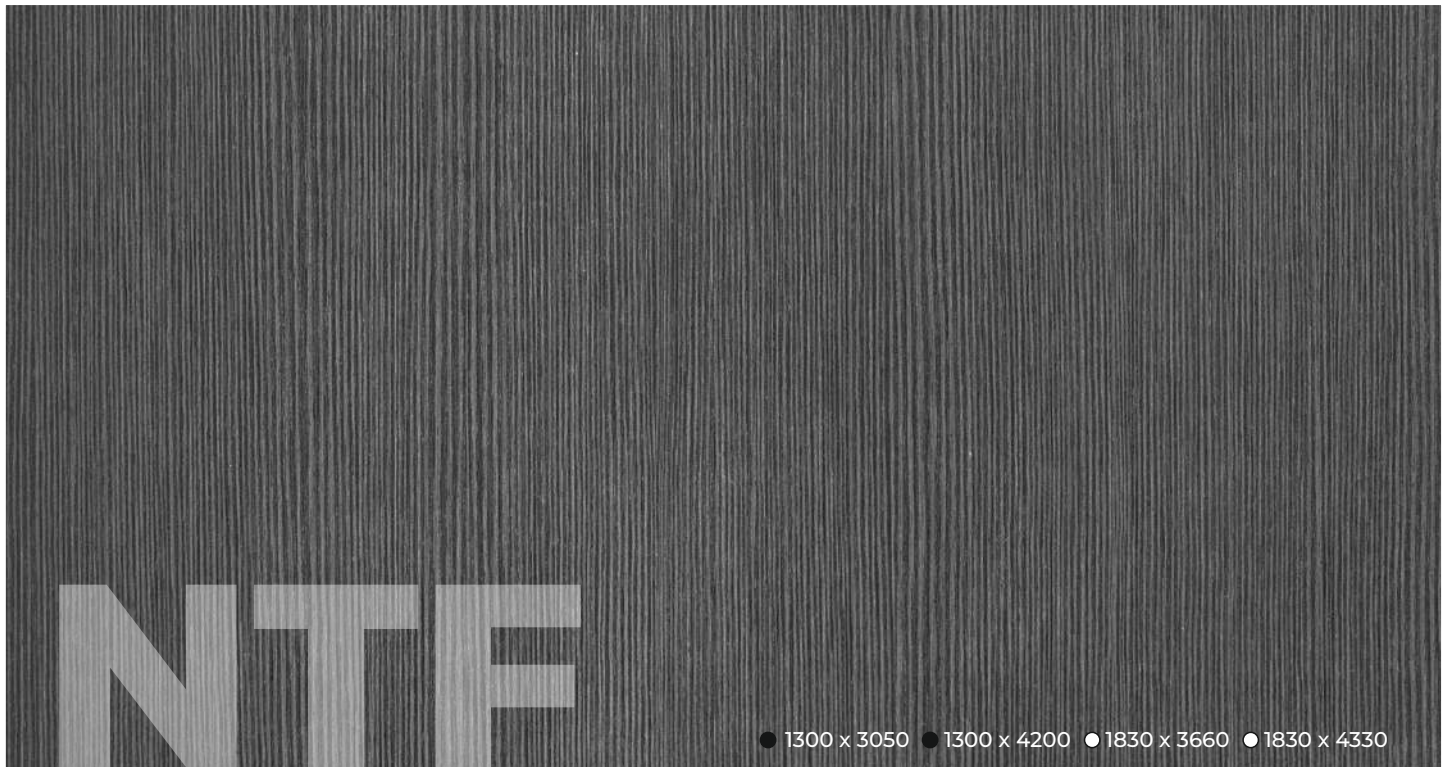

### PMT - Pure Matt

Pure Matt finish delivers a smooth, ultra-refined surface with a clean, contemporary look. Designed for minimal glare and easy maintenance, it adds understated elegance to modern interiors.



## RRF - Stones

RRF Stones finish showcases bold stone-inspired patterns with striking depth and character. Engineered for durability and visual impact, it brings a strong, contemporary stone aesthetic to interior surfaces.



## SLT - Slate

Slate finish reflects the raw elegance of natural stone with a subtle textured depth. Crafted to deliver a bold, contemporary look while ensuring durability and easy maintenance for everyday use.

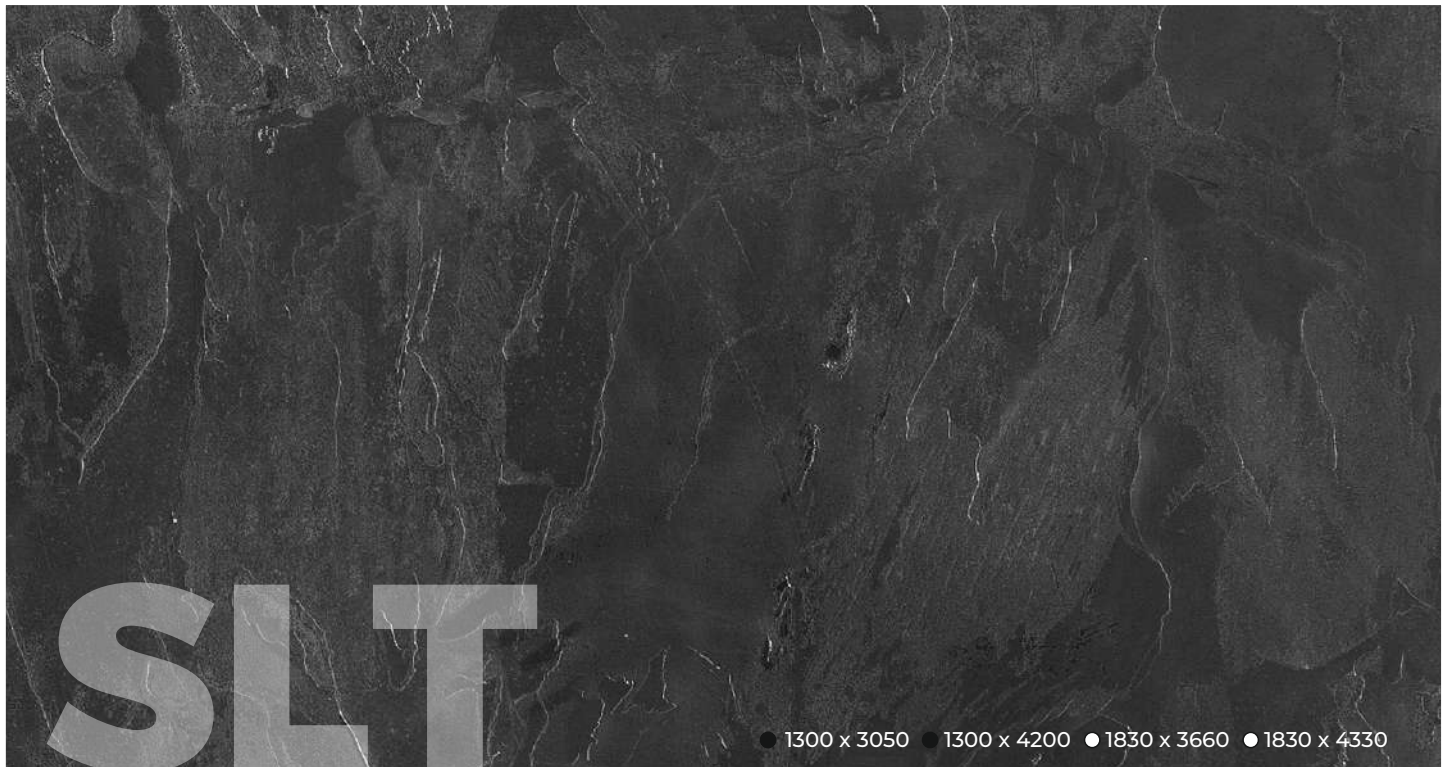

## RLT - Relic Stone

Relic Stone finish captures the timeless character of aged stone with rich texture and depth. Designed to bring a bold, heritage-inspired look with durable performance for modern interior surfaces.

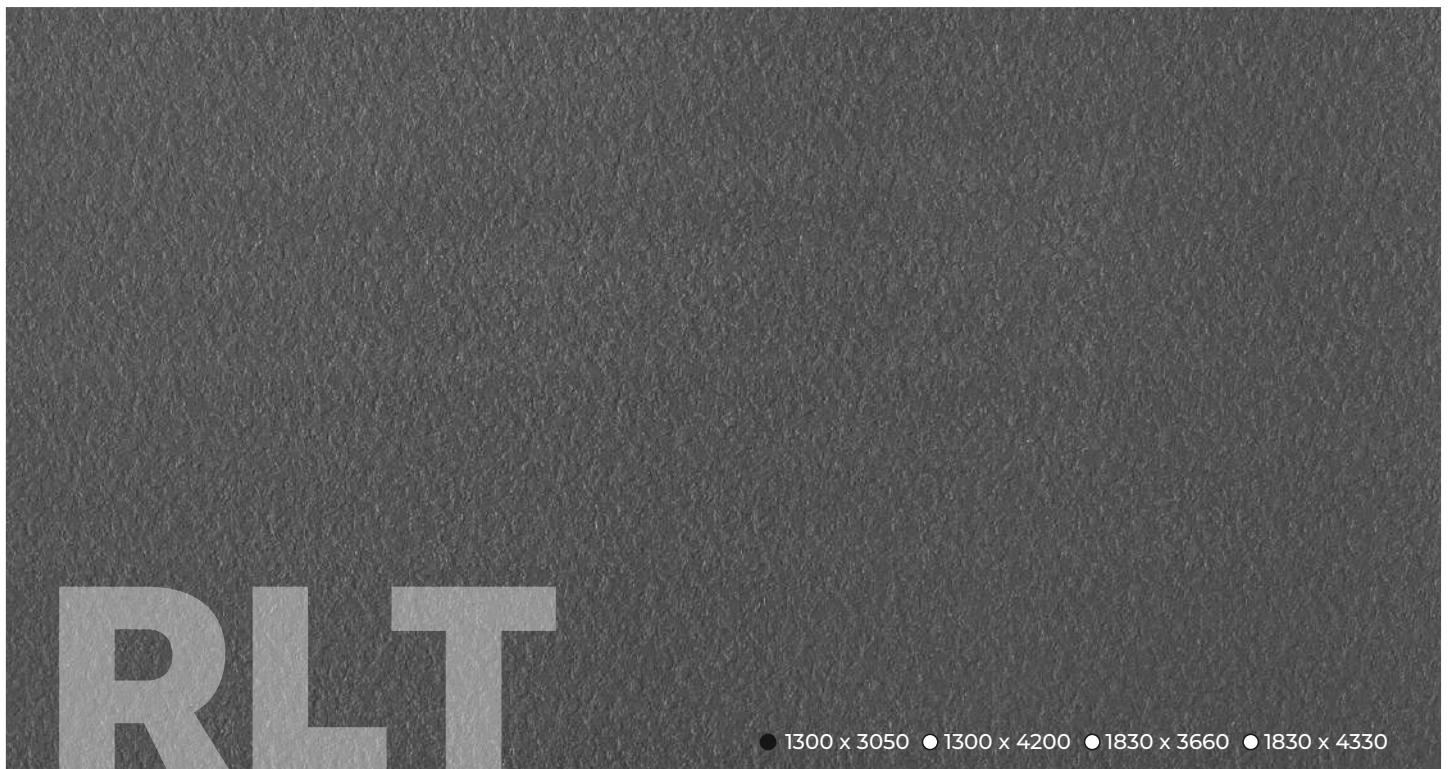

## TRF - Terra Stone

Terra Stone finish embodies the warmth and richness of earthy stone textures with natural depth. Crafted to bring grounded elegance and durable performance to contemporary interior surfaces.

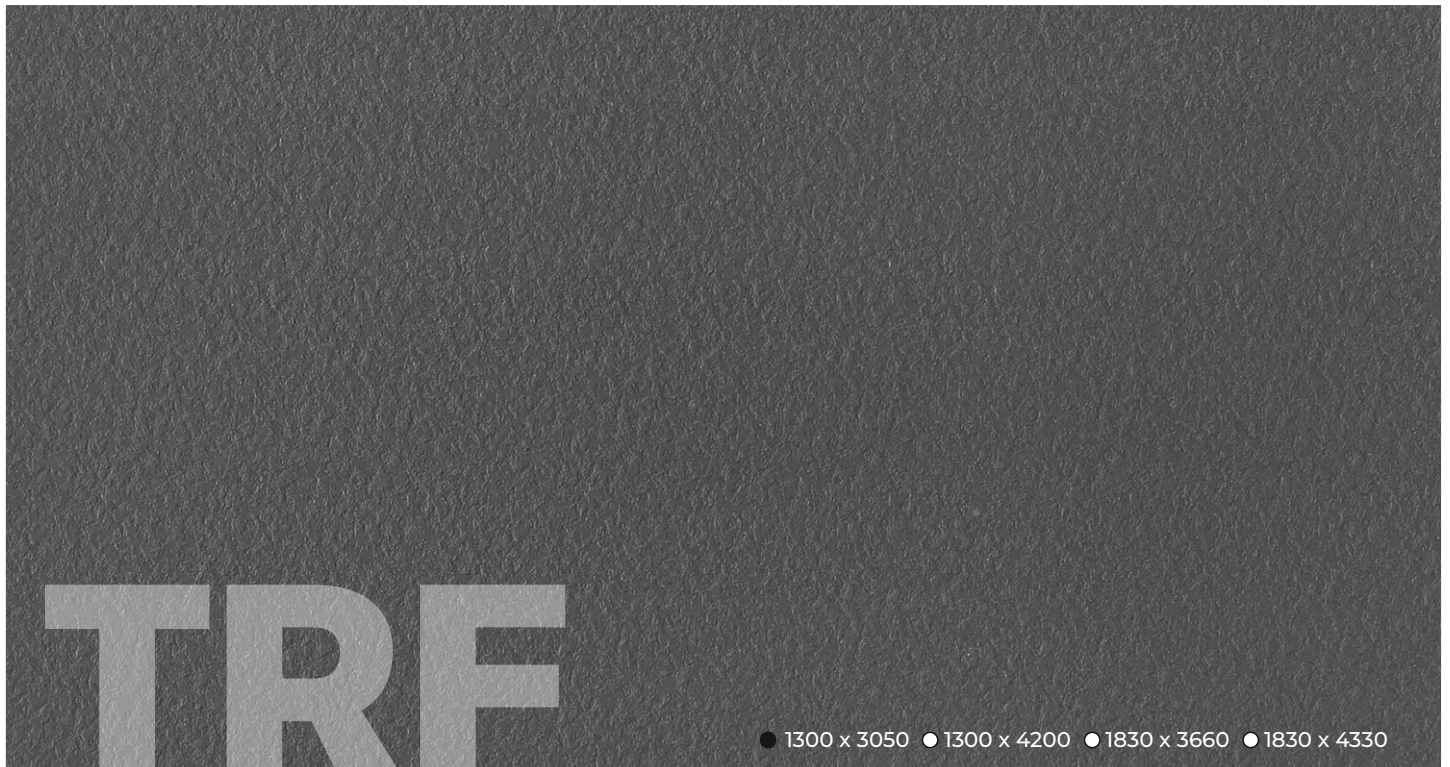



# Certifications & Standards



# Technical Datasheet

PROPERTIES	TEST METHOD	ATTRIBUTES OF PERFORMANCE	UNIT OF MEASUREMENT	RESULTS (AS PER EN 438-4)
Resistance to Surface wear	EN 438-2.10	Wear Resistance - Initial point	Revolutions	Unicolours - $\geq 150$ Printed Décor - $\geq 125$
Resistance to immersion in boiling water	EN 438-2.12	Mass increase - $2 \leq T < 5$ mm	%	CGS - $\leq 5$ , CGF - $\leq 7$
		Mass increases - $T \geq 5$ mm	%	CGS - $\leq 2$ , CGF - $\leq 3$
		Thickness increase - $2 \leq T < 5$ mm	Rating	CGS - $\leq 6$ , CGF - $\leq 9$
		Thickness increases - $T \geq 5$ mm	Rating	CGS - $\leq 7$ , CGF - $\leq 6$
		Appearance - Gloss finish	Rating	$\geq 3$
Resistance to water vapour	EN 438-2.14	Appearance - Gloss finish	Rating	$\geq 3$
		Appearance - Other finish	Rating	$\geq 4$
Resistance to dry heat (160°)	EN 438-2.16	Appearance - Gloss finish	Rating	$\geq 3$
		Appearance - Other finish	Rating	$\geq 4$
Dimensional stability at elevated temperatures	EN 438-2.17	Cumulative dimensional change - $2 \leq T < 5$ mm	L %	$\leq 0.40$
			T %	$\leq 0.80$
		Cumulative dimensional change - $T \geq 5$ mm	L %	$\leq 0.30$
			T %	$\leq 0.60$
Resistance to impact with large diameter ball	EN 438-2.21	Indent. Dia. 10mm $2 \leq T < 6$ mm - Drop	mm	$\geq 1400$
		Indent. Dia. 10mm $T \geq 6$ mm - Drop height	mm	$\geq 1800$
Resistance to Craziing	EN 438-2.24	Appearance	Rating	$\geq 4$
Resistance to Scratching	EN 438-2.25	Appearance - Smooth Finishes	Rating	$\geq 2$
		Appearance - Textured Finishes	Rating	$\geq 3$
Resistance to Staining	EN 438-2.26	Appearance - Group 1 & 2	Rating	$\geq 5$
		Appearance - Group 3	Rating	$\geq 4$
Light Fastness (Xenon arc)	EN 438-2.27	Contrast	Grey scale rating	4 to 5
Flexural modulus	EN ISO 178	Stress	Mpa	$\geq 9000$
Flexural strength	EN ISO 178	Stress	Mpa	$\geq 80$
Density	EN ISO1183	Density	gm/cm <sup>3</sup>	$\geq 1.35$

## Term & Conditions

\*All Dimensions are in mm

\*\*Standard panel sizes are manufactured with a tolerance of +10 / -0 mm in accordance with EN 438-6, section 5.3. For applications requiring precise dimensions and exact right angles, it is recommended to trim all edges. Please note that trimming may reduce the net size by approximately 10 mm, depending on the cutting method.

\*Overlay Film available on both sides on demand

\*FR Grade available on demand as per MOQ

\*All Images are only for reference.

images are for illustrative purposes only.













# Product Program

Decor	Type	Design No.	Design Name	RAL	LRV	Sizes				Exterior
						1300 x 3050	1300 x 4200	1830 x 3660	1830 x 4330	
	MGS	9362	Crystal Alba	####	####	●	●	○	○	●
	MGS	8582	Bonito	####	####	●	●	○	○	●
	MGS	9322	Calacatta Elegance			●	●	●	●	●
	MGS	9323	Arabescato			●	●	○	○	●
	MGS	9344	Bianco Venato			○	○	●	●	●
	MGS	9363	Lunara Stone			●	●	○	○	●
	MGS	12504	Rose Gold Marble			●	●	○	○	○
	MGS	9364	Golden Calma			●	●	○	○	●
	MGS	6612	Carrara Mist			●	●	○	○	○
	MGS	9306	Coral Stone			●	●	○	○	●
	MGS	9420	Diamond Tufting			○	○	●	●	○
	MGS	9333	Lunar Stone			●	●	○	○	●
	MGS	9359	Terra Crema			●	●	○	○	●
	MGS	9360	Terra Grigio			●	●	○	○	●
	MGS	12508	Travertino Grigio Light			●	●	○	○	●
	MGS	12509	Travertino Grigio Dark			●	●	○	○	●
	MGS	12510	Green Alta Gris			●	●	○	○	●
	MGS	8569	Kamala			●	●	○	○	●
	MGS	8697	Travertin Light			●	●	○	○	●
	MGS	8698	Travertin Dark			●	●	○	○	●
	MGS	9332	Stormy Stone			●	●	○	○	●
	MGS	9327	Grigio Carnico			●	●	○	○	●
	MGS	9328	Graphite Grey			●	●	○	○	●
	MGS	9330	Pietra Grey			●	●	○	○	●
	MGS	9329	Charcoal Marble			●	●	○	○	●
	MGS	3100	Paris Brown			●	●	○	○	●
	MGS	3200	Paris Grey			●	●	○	○	●
	MGS	9372	Nordic Ash			●	●	○	○	●
	MGS	8653	Perito			●	●	○	○	●
	MGS	6613	Luna Marble			●	●	○	○	○
	MGS	8913	Moiten Granite			●	●	○	○	○
	MGS	9361	Nordic Grey			●	●	○	○	●
	MGS	8656	Sinope Marble			●	●	○	○	●
	MGS	9324	Tuscany Grey			●	●	○	○	●
	MGS	8663	Venice			●	●	○	○	●
	MGS	1431	Desert Mirage			●	●	○	○	○
	MGS	1414	Creamy Onyx			●	●	○	○	○
	MGS	1418	Desert Stone			●	●	○	○	○
	MGS	9416	Grey Caldera			○	○	●	●	○
	MGS	9417	Graphite Strata			○	○	●	●	○
	MGS	9418	Charcoal Quarry			○	○	●	●	○
	MGS	9419	Burnt Orange			○	○	●	●	○
	MGS	9366	Carbon Strata			●	●	○	○	●
	MGS	8654	Zebra Mable			●	●	○	○	●
	MGS	4602	Greystone			●	●	●	●	●
	MGS	9373	Eclipse Marble			●	●	○	○	●
	MGS	9325	Midnight Marquina			●	●	○	○	●
	MGS	9326	Midnight Onyx			●	●	○	○	●
	MGS	9365	Regal Onyx			●	●	○	○	●
	MGS	9374	Eclipse Gold			●	●	○	○	●
	W&V	9404	Baltic Birchwood			○	○	●	●	●
	W&V	7599	Moldau Acacia Light			●	●	●	●	●
	W&V	9379	Ivory Softwood			●	●	○	○	●
	W&V	9412	Ivory Beech			○	○	●	●	●
	W&V	9413	Pearl Wood			○	○	●	●	●
	W&V	9414	Vanilla Birch			○	○	●	●	●

Decor	Type	Design No.	Design Name	RAL	LRV	Sizes				Exterior
						1300 x 3050	1300 x 4200	1830 x 3660	1830 x 4330	
	W&V	9371	Nordic Maple			○	○	●	●	●
	W&V	7632	Thansau Maple			○	○	●	●	●
	W&V	8536	Canyon Wood Light			●	●	○	○	●
	W&V	9407	Vintage Timber Light			○	○	●	●	●
	W&V	9137	Nogalino			●	●	○	○	●
	W&V	9375	Timbercliff Umber			●	●	○	○	●
	W&V	4663	Santana Oak Light			●	●	●	●	●
	W&V	9321	Vintage Barrel Oak			●	●	○	○	●
	W&V	9402	Baltic Maple			○	○	●	●	●
	W&V	9356	Espresso Oak			●	●	●	●	●
	W&V	9403	European Alder			○	○	●	●	●
	W&V	1130	Bavarian Beech			●	●	●	●	●
	W&V	9357	Caramel Teak			●	●	●	●	●
	W&V	8537	Canyon Wood Dark			●	●	●	●	●
	W&V	8627	Novecento Pine			●	●	●	●	●
	W&V	9411	Royal Beech			○	○	●	●	●
	W&V	2164	Malasian Cherry			●	●	●	●	●
	W&V	7129	Mangfall Beech			○	○	●	●	●
	W&V	4664	Santana Oak Dark			○	○	●	●	●
	W&V	9378	Shadowcrest Wood			●	●	○	○	●
	W&V	9410	Warmwood Elite			○	○	●	●	●
	W&V	9405	Heritage Alder			○	○	●	●	●
	W&V	1400	Walnut Tiepolo			●	●	○	○	●
	W&V	8625	Lyon Walnut			●	●	●	●	●
	W&V	9406	Toffee Timber			○	○	●	●	●
	W&V	3152	Moldau Acacia			●	●	●	●	●
	W&V	9376	Heritage Brownwood			●	●	○	○	●
	W&V	8626	Columbia Walnut			●	●	●	●	●
	W&V	9408	Vintage Timber Dark			○	○	●	●	●
	W&V	8629	Khaya Mahogany Dark			●	●	○	○	●
	W&V	9409	Natural Teakwood			○	○	●	●	●
	W&V	4538	Bengali Mango Dark			○	○	●	●	●
	W&V	9377	Strata Darkwood			●	●	○	○	●
	W&V	9367	Mocha Timber			○	○	●	●	●
	W&V	9415	Elite Walnut			○	○	●	●	●
	S&U	4001	Milky White	9003	80.28	●	●	●	●	●
	S&U	3001	Snow White	110-1	76.37	●	●	●	●	●
	S&U	1065	Ivory Pearl	9016	81.27	●	●	●	●	●
	S&U	1089	Pale Sand	110 90 05	68.81	●	●	●	●	●
	S&U	1064	Cream Soft	120-3	80.44	●	●	●	●	●
	S&U	6002	Snowflake	9010	81.18	●	●	●	●	●
	S&U	1069	Cream Sand	140-5	70.52	●	●	●	●	●
	S&U	1060	Soft Beige	070 80 10	50.49	●	●	●	●	●
	S&U	1084	Dark Cocoa	050 30 10	5.39	●	●	●	●	●
	S&U	1070	Silver Tone	870-1	59.42	●	●	●	●	●
	S&U	2008	Grey	860-3	51.2	●	●	●	●	●
	S&U	1071	Cement Light	7035	52.65	●	●	●	●	●
	S&U	1076	Urban Ash	820-M	30.73	●	●	●	●	●
	S&U	1078	Warm Taupe	120-M	29.33	●	●	●	●	●
	S&U	1057	Graphite Dark	7024	6.16	●	●	●	●	●
	S&U	7057	Carbon Grey	810-M	6.52	●	●	●	●	●
	S&U	1015	Jade Black	9017	3.91	●	●	●	●	●



Download  
E-catalogue



**Corporate Office:**

Rushil Decor Ltd., Rushil House,  
Near Neelkanth Green Bungalow,  
Off Sindhu Bhavan Road, Shilaj,  
Ahmedabad-380059, Gujarat, India.

**Contact Us:**

Ph. No.: +91-79-61400400  
Toll Free No.: 1800 233 7952  
info@rushil.com | www.rushil.com